

Adjustable-Grip Draw Latch

Zinc-Plated Steel, 5-3/16" Long x 3" Wide

\$21.58 Each  
1807A57

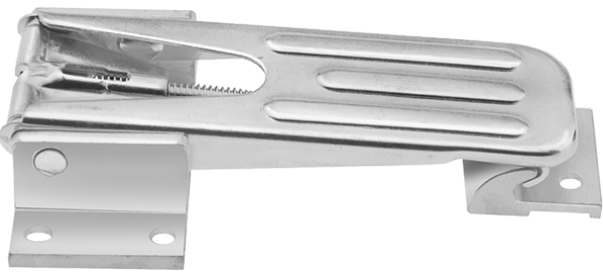

	C
Material	Zinc-Plated Steel
Appearance	Dull
Strike Plate Material	Aluminum
Latching Distance	2 3/4"-3 1/4"
Overall	
Length	5 3/16"
Width	3"
Projection	1 1/16"
Capacity	Not Rated
Mount Type	Screw On
Mounting	
Style	Surface
Fasteners Included	No
Screw Size	No. 10
Draw Latch Type	Nonlocking
Latching Distance Adjustability	Adjustable
RoHS	RoHS 3 (2015/863/EU) Compliant
REACH	REACH (EC 1907/2006) (01/17/2022, 223 SVHC) Compliant
DFARS	Specialty Metals COTS-Exempt
Country of Origin	Peoples Republic of China
Schedule B	830249.7500
ECCN	EAR99

Adjust the latching distance to compensate for gasketing and misalignment. Capacity is the maximum amount of force the latch can withstand. The overall length listed includes the strike plate; it's measured with the latch extended to maximum latching distance.

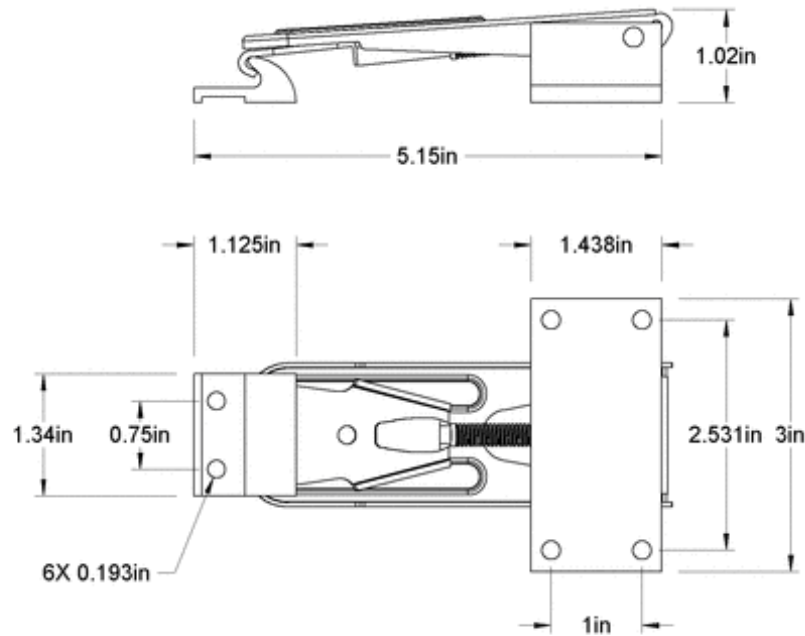

**McMASTER-CARR®**   
<http://www.mcmaster.com>  
 © 2021 McMaster-Carr Supply Company  
 Information in this drawing is provided for reference only.

PART NUMBER **1807A57**  
 Adjustable-Grip  
 Draw Latch

The information in this 3-D model is provided for reference only.