

Crank-up lift system

How to disassemble torsion bar from camper roof

1. Raise roof to upright position (roof must be in full up position)
2. Block up or support roof so it can not fall down
3. Remove 3/8 x 3 rear roof support center pivot bolt
4. Remove 3/8 x 3 front roof support center pivot bolt.
5. Remove small set screw at the top of both roof supports
6. Have second person pull towards the middle of the camper on the rear roof support while the person in the front of the camper removes the lower bolt on the front roof support. (By pulling in on the rear roof support it will take the tension off the front roof support making it easier to take the lower bolt out)
7. Slide front & rear roof supports down to disassemble from torsion bar legs.
8. Remove front bolt on torsion bar pivot to drop torsion bar assembly down and slide assembly foreword to disassemble it from the anchor in the back of the roof.
9. Now you can replace torsion bar or rear anchor on that side.
10. When reassembling torsion bar to rear anchor, make sure that when the hexes in the torsion bar assembly align with the back anchor, the legs coming down on the torsion bar assembly **are** pointing towards the outside of the camper not towards the middle of the camper.
11. Reverse procedure starting with #8 to reassemble the rest of the lift system.

See exploded view of lift system assembly attached with these instructions.

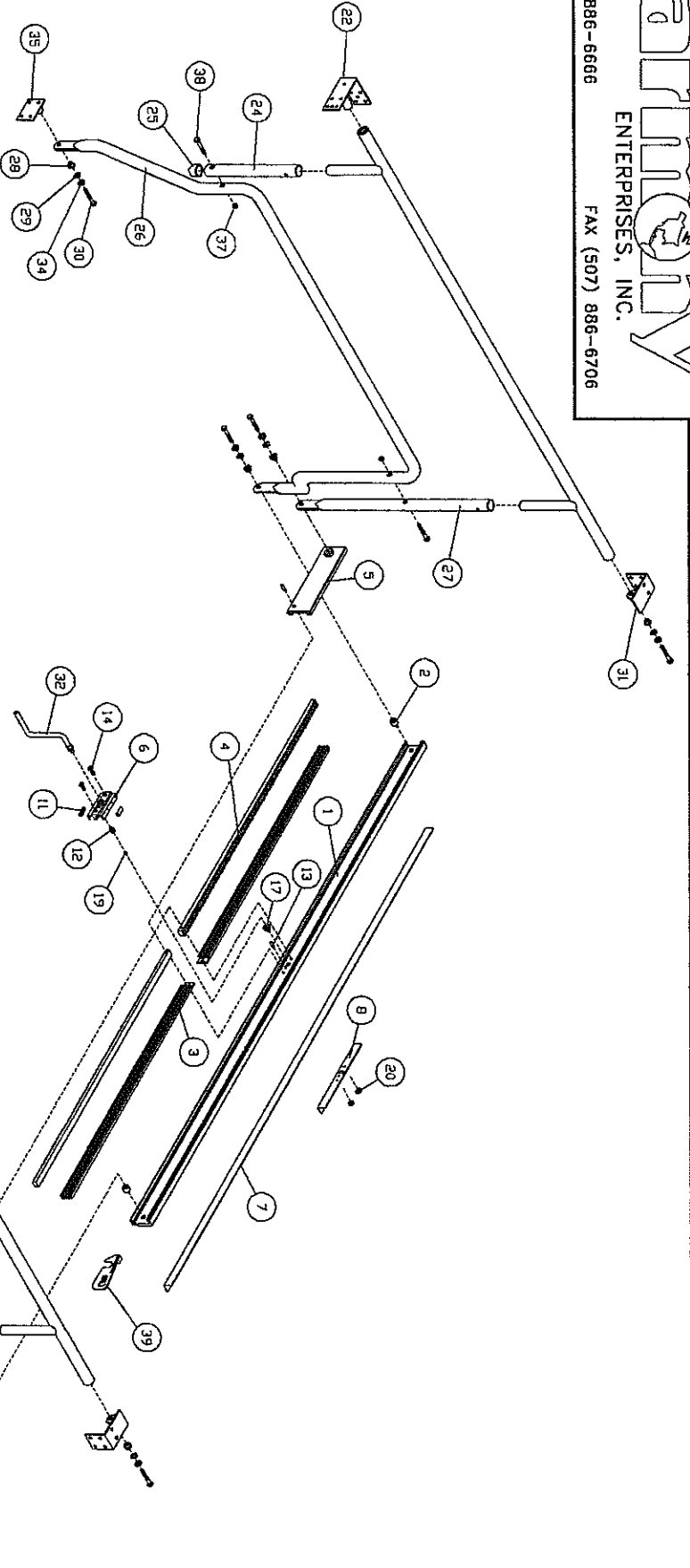

ITEM	QTY	DESCRIPTION	PART NO.	ITEM	QTY	DESCRIPTION	PART NO.
1	1	RAIL	-253	22	1	ANCHOR-TORSION BAR-LEFT	-186L
2	2	PIVOT	589-414	23	1	TORSION BAR TUBE-RIGHT	-176A
3	2	VINYL GUIDE	-371	1		TORSION BAR	-262
4	2	RACK GEAR	-373	24	2	ROOF SUPPORT-REAR	-417
5	2	SLIDE	-255A	25	2	VINYL CAP	U-151
6	1	GEAR HOUSING	-368A	26	1	ROOF SUPPORT-LOWER LEFT	-416AL
7	1	ANGLE	1986	27	2	ROOF SUPPORT-FRONT	-415
8	1	ANGLE	1678	28	8	BUSHING	U-266
10	14	POP RIVET	9084	29	8	5/16 FLAT WASHER	9086
11	2	THRUST PAD	100-372	30	8	5/16X3/4" HEX HD CAP SCR	9044
12	1	IDLER PINION	U-375	31	2	PIVOT-TORSION BAR	-187
13	1	IDLER SHAFT	U-376	32	1	CRANK	U-377A
14	2	1/4-20 X 1 1/4 FL HD SCR	9128	33	1	ROOF SUPPORT-LOWER RIGHT	-416AR
15	1	PATENT DECAL	1675	34	8	5/16" LOCK WASHER	9038
16	2	3/16 X 5/8 STEEL TENS	1540	35	2	PIVOT	-185
17	1	BUSHING	387-378	36	1	ANCHOR-TORSION BAR RIGHT	-186R
18	1	WARNING LABEL	DEC-110	37	4	3/8"-16 UNITORQUE LOCKNUT	9143
19	1	INDUSTRIAL RETAINING	1674	38	4	3/8X3" STR THREAD BOLT	9062
20	2	1/4"-20 SELF LOCK HEX NUT	9011	39	1	LOCK	631-435
21	1	WARNING ENG LABEL	2005				