



FOUR WHEEL CAMPERS, INC.

... MANUFACTURERS OF FINE CAMPERS ...

Traveland USA • East Irvine, California 92650 • 1-714 552-8370
11387 Pyrite Way • Sacramento, California 95670 • 1-916-638-1203

KEYSTONE

9' 3" Slide In

(Fleet Side Only)

\$4,395.00

Freight from Denver \$220.00

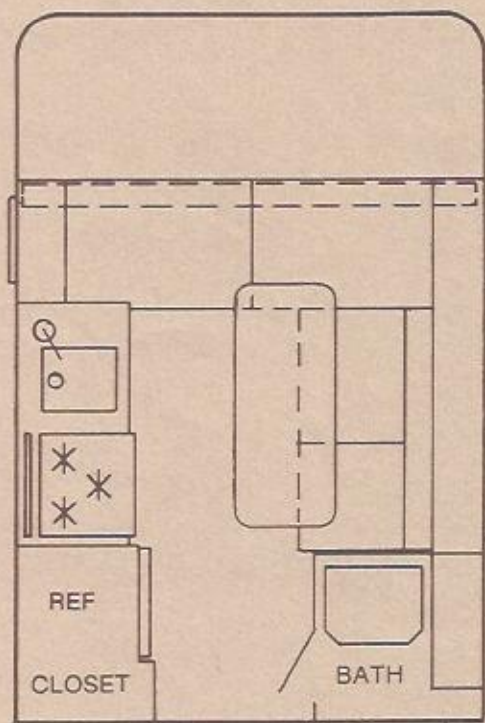

Sleeps 4 Adults

STANDARD EQUIPMENT

The Keystone Model Four Wheel Camper includes as standard equipment: 16,000 BTU automatic forced air furnace, 3 burner stove and safety cover, stainless steel sink with cutting board cover, 75# ice box, 20 lb. L.P. gas supply system, 16 gallon water supply with hand pump, mechanical roof vent, two dual lights and two single light fixtures, 12 volt porch light, deluxe nylon cushions, decorator curtains for all windows, closet (8 c.f.), enclosed bathroom with overhead light and porta pottie, queen size overhead bed, stop, turn, and back-up lights, overhead storage, rear wardrobe mirror, bath vanity cabinet, washable cherry wood interior, fully insulated for all seasons, easy lift roof support system, 2BC fire extinguisher, emergency exit window, outside storage doors, will sleep four adults, and includes installation on your vehicle.

OPTIONAL EQUIPMENT

Four Burner Stove with Oven	\$195.00
Hot Water Heater (in closet - closet depth 15" - incl. pressure demand pump)	\$385.00
Pressure Demand Pump	\$ 85.00
110V System w/o Converter (2 double outlets - 25 ft. power cord)	\$ 95.00
110V Converter (changes 110V power to 12V)	\$130.00
2nd Roof Vent (Above Overhead Bed)	\$ 25.00X
3-Way Refrigerator (LP Gas - 12V - 3 cu. ft. - inc. 110V system)	\$495.00X
Elec. Water Pump (cabinet switch)	\$ 35.00
Front Sliding Window (opens to cab)	\$ 57.00X
Boot for Sliding Window (opens to cab)	\$ 19.95X
Full Size Camper Boot (replaces cab and camper window)	\$150.00
Torque Window (in bath or DS front)	\$ 15.00X

ACCESSORIES AVAILABLE

2 Tier Step (up to 27" high)	inst. \$ 37.50
3 Tier Step (up to 35" high)	inst. \$ 42.50
Rear Step - sets on ground 10" high	\$ 17.89
Front Tire Carrier	inst. \$ 37.50
Side Sun Awning	\$ 68.00
Camper Jacks (free standing - one pair)	\$161.50X
Luggage Rack (30" X 80" - 300 lb. capacity)	\$ 65.00
Boat Rack (front & rear - 200 lb. capacity)	\$ 35.00
Luggage/Boat Combination Rack	\$ 80.00
Auxiliary Battery (105 Amp deep cycle & relay) Installed	\$165.00
Stove Striker	\$ 5.90
Bolt-On Side Mirrors	inst. \$ 49.95
Rear Cab Sliding Window (for pick-up)	inst. \$ 65.00

SPECIFICATIONS

Dry Weight	1,075 lbs.	Height over cab (down)	12"
Floor Length	111"	Added width each side	1"
Roof Length	144"	Height down (inc. vent)	55"
Width	80"	Extended interior height	6' 1"
Adult Sleeping	4	Approx. length increase	7"
		Slide-In Installation	
		Bolt Down	

Prices do not include sales tax or delivery and handling charges. Dealer prices will vary according to location from Denver, Colorado. Models not in stock may be ordered from your nearest dealer or directly from the factory in Denver by phone or mail. A deposit of \$300.00 is required on all camper sales. Contact your nearest dealer for his current price and stock or construction time.